



# QUICK COUPLINGS

**SH TYPE**

High pressure • Twin valve



NAGAHORI INDUSTRY CO., LTD.

# SH TYPE High pressure Twin valve

**Stainless steel material is excellent resistance to corrosion.**  
**Suitable for hard circumstance : iron works, on board**

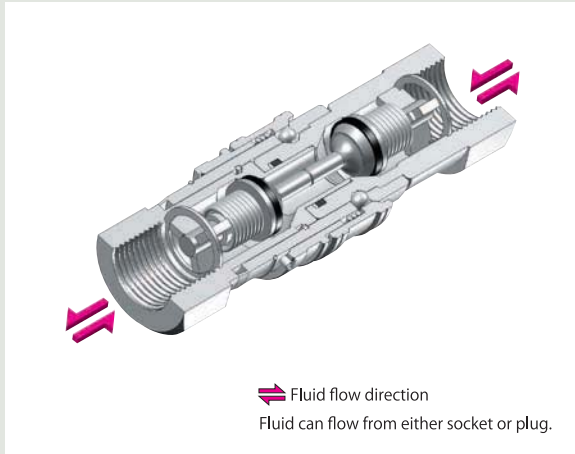

## Features

- Both socket and plug have automatic shut-off valves under working pressure of 20.5MPa.
- Double-sleeve lock mechanism assures tight connection against vibration and impact.
- Putting dust covers on sockets and plugs are recommendable when they are disconnected.

## Flow rate - Pressure drop characteristics

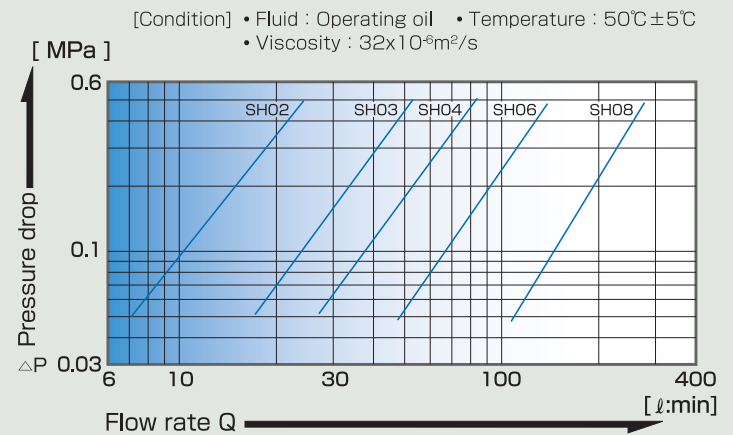

## Packing material and temperature's range

Packing material	Symbol	Temperature *1	Characteristics *2
Nitrile rubber	NBR	-20°C~+ 80°C	Oil resistance
Fluoro rubber	FKM	-20°C~+180°C	Heat, oil resistance

\*1 By the environment of one's using, it has a case that the appropriate temperature differs from this table. Continuous use by above minimum/ maximum temperature causes a leakage and so on.

\*2 Above characteristics are standard. O-ring durability depends on the temperature of fluid, kinds of chemicals and viscosity.

## STAINLESS STEEL(SUS304)

### SOCKET

Model	Weight (g)	Connection size(T)	Dimensions(mm)		
			L	φD	H
CSH02S3	138	Rc 1/4"	59	27	φ22/Face19
CSH03S3	228	Rc 3/8"	68	32	φ28/Face24
CSH04S3	404	Rc 1/2"	81	40	φ35/Face30
CSH06S3	704	Rc 3/4"	97	48	φ44/Face38
CSH08S3	1382	Rc 1"	118	62	φ58/Face50

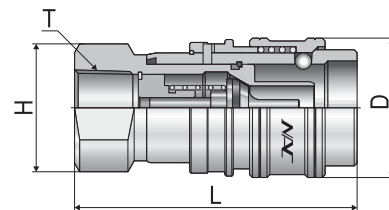

### PLUG

Model	Weight (g)	Connection size(T)	Dimensions(mm)		
			L	H	ℓ
CSH02P3	74	Rc 1/4"	50	φ22/Face19	20
CSH03P3	128	Rc 3/8"	59	φ28/Face24	24
CSH04P3	240	Rc 1/2"	70.5	φ35/Face30	28
CSH06P3	448	Rc 3/4"	81.5	φ44/Face38	35.6
CSH08P3	934	Rc 1"	100	φ58/Face50	47.5

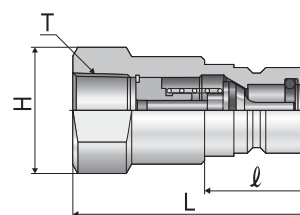

\*Please read "User safety guide" before operation.



Stainless steel  
(SUS304)



Twin valve



Fluoro rubber



Water



Oil



Gas



## Cautions

- Packing material should be selected for the applicable fluid.
- Different sizes are not interchangeable.
- When mounting on the male thread, excessive tightening may cause the crack of the couplings.
- Do not apply pressure on a socket or a plug when disconnecting. It may damage the valve.
- Scraps of the seal tape and dust cause fluid leakage. Be careful not to stick them on the couplings.
- When connecting to a female thread or a hose, please use a nipple.

## SOCKET



## PLUG

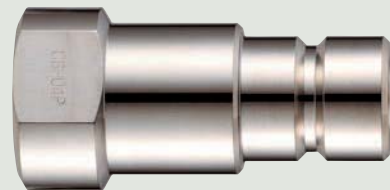

### Double sleeve lock mechanism

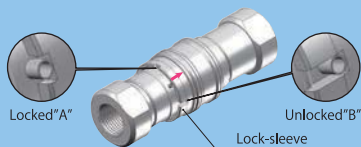

SH type has two ditches. When a pin falls into the small ditch "A" of lock sleeve, the socket and the plug are locked.



## Specifications

Model	CSH02	CSH03	CSH04	CSH06	CSH08
Nominal size	1/4"	3/8"	1/2"	3/4"	1"
Nominal pipe size	8A	10A	15A	20A	25A
Body material	Stainless steel(SUS304)				
Connection type	Female thread only				
Packing material, Temperature range *1	Fluoro rubber(FKM) : -20℃~+180℃				
Normal pressure	20.5MPa				
Maximum pressure	31.0MPa				
Applicable fluid *2	Water, Oil, Gas				
Accessory	Dust cover				

\*1 By the environment of one's using, it has a case that the appropriate temperature differs from this table. Continuous use by above minimum/maximum temperature causes a leakage and so on.

\*2 Above characteristics are standard. O-ring durability depends on the temperature of fluid, kinds of chemicals and viscosity.

## Flow's smallest area

Unit (mm<sup>2</sup>)

Model	CSH02	CSH03	CSH04	CSH06	CSH08
Smallest area	26	47	84	153	233

